

04-4390-Departmental

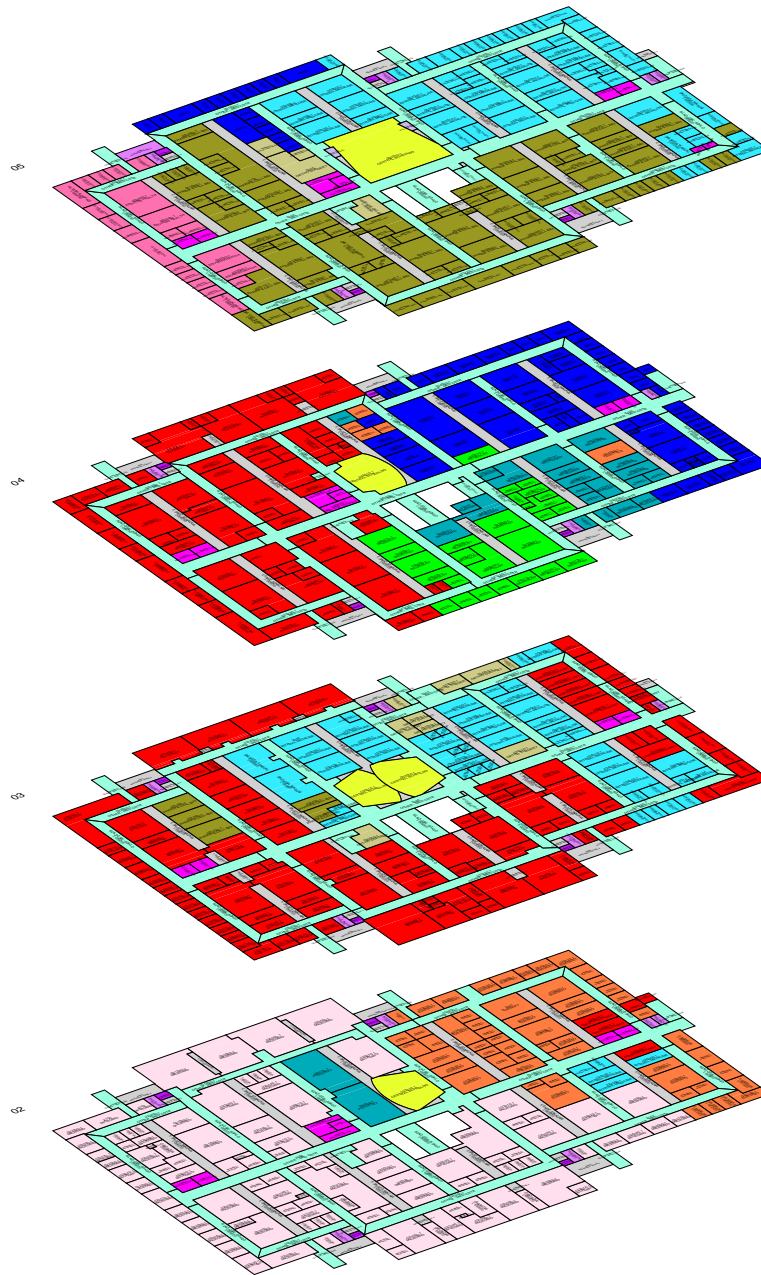

	No data	11	0.00%
	ANESTHESIOLOGY	5,151	1.91%
	PHYSOLGY	24,250	8.98%
	MICROBIO	29,484	10.92%
	BIOCHEM	19,630	7.27%
	INTRNAL MEDICINE	24,633	9.12%
	PHYS MED	2,306	0.85%
	SURGERY	10,693	3.96%
	NEUROSRG	4,502	1.67%
	OB/GYN	12,609	4.67%
	ORTHO SURGERY	3,068	1.14%
	NEUROLOGY	5,902	2.19%
	PEDATRCs	789	0.29%
	PSYCHTRY	1,808	0.67%
	PHARM & CELL BIO	21,948	8.13%
	ENVIRON HEALTH	4,523	1.68%
	HTH SCI LIBRARY	92	0.03%
	TELECO	629	0.23%
	HSEKPNG ZONE 3	1,746	0.65%
	MNTNCE ZONE 3	23,456	8.69%
	MED CTR UTILITIES	3,243	1.20%
	OTHER - MED CNTR	63,513	23.53%
	CENTRAL SCHEDLNG	5,986	2.22%

Space Summary Report by Heirarchy

August 4, 2009

University of Huntington

Page 1 of 1

Comments: Demonstration Report

Cost Center	Budget Code	Net Area	Charged Area	Rate	Monthly Cost	Annual Cost
Medical						
ANESTHESIOLOGY	13015	5,151.39	5,151.39	\$10.00	\$4,292.83	\$51,513.91
PHYSOLGY	13021	24,249.53	24,249.52	\$10.00	\$20,207.93	\$242,495.19
MICROBIO	13025	29,484.35	29,484.35	\$10.00	\$24,570.29	\$294,843.45
BIOCHEM	13027	19,630.05	19,630.04	\$10.00	\$16,358.37	\$196,300.42
INTRNAL MEDICINE	13033	24,633.14	24,633.13	\$10.00	\$20,527.61	\$246,331.28
PHYS MED	13037	2,305.69	2,305.69	\$10.00	\$1,921.41	\$23,056.86
SURGERY	13041	10,692.54	10,692.54	\$10.00	\$8,910.45	\$106,925.41
NEUROSRG	13042	4,502.40	4,502.40	\$10.00	\$3,752.00	\$45,024.01
OB/GYN	13045	12,608.67	12,608.67	\$10.00	\$10,507.22	\$126,086.69
ORTHO SURGERY	13048	3,067.80	3,067.80	\$10.00	\$2,556.50	\$30,677.97
NEUROLGY	13051	5,902.06	5,902.06	\$10.00	\$4,918.38	\$59,020.60
PEDATRCS	13061	788.74	788.74	\$10.00	\$657.28	\$7,887.36
PSYCHTRY	13071	1,807.51	1,807.51	\$10.00	\$1,506.26	\$18,075.14
PHARM & CELL BIO	13091	21,948.18	21,948.17	\$10.00	\$18,290.14	\$219,481.69
ENVIRON HEALTH	13096	4,523.24	4,523.23	\$10.00	\$3,769.36	\$45,232.34
HTH SCI LIBRARY	32038	92.22	92.22	\$10.00	\$76.85	\$922.24
TELECO	36087	629.24	629.24	\$10.00	\$524.37	\$6,292.43
HSEKPNG ZONE 3	38022	1,745.53	1,745.53	\$10.00	\$1,454.61	\$17,455.34
MNTNCE ZONE 3	38042	23,456.39	23,456.38	\$10.00	\$19,546.98	\$234,563.80
MED CTR UTILITIES	38092	3,242.93	3,242.93	\$10.00	\$2,702.44	\$32,429.26
OTHER - MED CNTR	39062	63,512.98	63,512.96	\$10.00	\$52,927.46	\$635,129.57
CENTRAL SCHEDLNG	99999	5,986.44	5,986.44	\$10.00	\$4,988.70	\$59,864.42
Medical Total		269,961.03	269,960.94	\$10.00	\$224,967.45	\$2,699,609.39
Univ of Huntington Total		269,961.03	269,960.94	\$10.00	\$224,967.45	\$2,699,609.39
Project Total		269,972.36	269,972.27	\$10.00	\$224,967.45	\$2,699,609.39

04-4390-02-Departmental



- ANESTHESIOLOGY
878 SF 1.30%
- MICROBIO
29,484 SF 43.68%
- INTRNAL MEDICINE
933 SF 1.38%
- SURGERY
10,693 SF 15.84%
- PSYCHTRY
1,808 SF 2.68%
- TELECO
173 SF 0.26%
- HSEKPNG ZONE 3
453 SF 0.67%
- MNTNNCE ZONE 3
5,852 SF 8.67%
- MED CTR UTILITIES
902 SF 1.34%
- OTHER - MED CNTR
15,375 SF 22.78%
- CENTRAL SCHEDLNG
942 SF 1.40%

2nd Floor

University of Huntington
Hostetler Research Building
 0 5 10 20 30 40 60

Space Summary Report by Floor

August 4, 2009

University of Huntington

Page 1 of 4

Floor: 02

Comments: Demonstration Report

<u>Cost Center</u>	<u>Budget Code</u>	<u>Net Area</u>	<u>Charged Area</u>	<u>Rate</u>	<u>Monthly Cost</u>	<u>Annual Cost</u>
ANESTHESIOLOGY	13015	877.69	877.69	\$10.00	\$731.41	\$8,776.91
MICROBIO	13025	29,484.35	29,484.35	\$10.00	\$24,570.29	\$294,843.45
INTRNAL MEDICINE	13033	932.96	932.96	\$10.00	\$777.47	\$9,329.58
SURGERY	13041	10,692.54	10,692.54	\$10.00	\$8,910.45	\$106,925.41
PSYCHTRY	13071	1,807.51	1,807.51	\$10.00	\$1,506.26	\$18,075.14
TELECO	36087	173.14	173.14	\$10.00	\$144.28	\$1,731.39
HSEKPNG ZONE 3	38022	453.50	453.50	\$10.00	\$377.92	\$4,535.00
MNTNNCE ZONE 3	38042	5,851.84	5,851.84	\$10.00	\$4,876.53	\$58,518.36
MED CTR UTILITIES	38092	902.27	902.27	\$10.00	\$751.90	\$9,022.74
OTHER - MED CNTR	39062	15,374.88	15,374.88	\$10.00	\$12,812.40	\$153,748.81
CENTRAL SCHEDLNG	99999	942.41	942.41	\$10.00	\$785.34	\$9,424.06
	Floor Total	67,493.09	67,493.09	\$10.00	\$56,244.24	\$674,930.86

04-4390-03-Departmental

- ANESTHESIOLOGY
4,274 SF 6.33%
- PHYSOLGY
4,625 SF 6.85%
- BIOCHEM
19,630 SF 29.08%
- INTRNAL MEDICINE
10,897 SF 16.15%
- ORTHO SURGERY
1,833 SF 2.72%
- PHARM & CELL BIO
1,581 SF 2.34%
- TELECO
147 SF 0.22%
- HSEKPNG ZONE 3
383 SF 0.57%
- MNTNNCE ZONE 3
5,853 SF 8.67%
- MED CTR UTILITIES
475 SF 0.70%
- OTHER - MED CNTR
16,049 SF 23.78%
- CENTRAL SCHEDLNG
1,747 SF 2.59%



3rd Floor

University of Huntington
Hostetler Research Building

Space Summary Report by Floor

August 4, 2009

University of Huntington

Page 2 of 4

Floor: 03

Comments: Demonstration Report

<u>Cost Center</u>	<u>Budget Code</u>	<u>Net Area</u>	<u>Charged Area</u>	<u>Rate</u>	<u>Monthly Cost</u>	<u>Annual Cost</u>
ANESTHESIOLOGY	13015	4,273.70	4,273.70	\$10.00	\$3,561.42	\$42,737.00
PHYSOLGY	13021	4,625.28	4,625.28	\$10.00	\$3,854.40	\$46,252.83
BIOCHEM	13027	19,630.05	19,630.04	\$10.00	\$16,358.37	\$196,300.42
INTRNAL MEDICINE	13033	10,896.90	10,896.89	\$10.00	\$9,080.74	\$108,968.92
ORTHO SURGERY	13048	1,833.15	1,833.15	\$10.00	\$1,527.63	\$18,331.52
PHARM & CELL BIO	13091	1,580.56	1,580.56	\$10.00	\$1,317.13	\$15,805.62
TELECO	36087	147.07	147.07	\$10.00	\$122.56	\$1,470.69
HSEKPNG ZONE 3	38022	382.97	382.97	\$10.00	\$319.14	\$3,829.65
MNTNNCE ZONE 3	38042	5,852.84	5,852.84	\$10.00	\$4,877.37	\$58,528.43
MED CTR UTILITIES	38092	474.91	474.91	\$10.00	\$395.76	\$4,749.10
OTHER - MED CNTR	39062	16,048.97	16,048.97	\$10.00	\$13,374.14	\$160,489.66
CENTRAL SCHEDLNG	99999	1,746.68	1,746.68	\$10.00	\$1,455.57	\$17,466.83
	Floor Total	67,493.09	67,493.07	\$10.00	\$56,244.22	\$674,930.66

04-4390-04-Departmental

- PHYSOLGY**
19,624 SF 29.08%
- NEUROSRG**
4,502 SF 6.67%
- OB/GYN**
12,609 SF 18.68%
- NEUROLOGY**
5,902 SF 8.74%
- PEDATRCS**
789 SF 1.17%
- TELECO**
150 SF 0.22%
- HSEKPNG ZONE 3**
229 SF 0.34%
- MNTNNCE ZONE 3**
5,970 SF 8.85%
- MED CTR UTILITIES**
918 SF 1.36%
- OTHER - MED CNTR**
15,829 SF 23.45%
- CENTRAL SCHEDLNG**
971 SF 1.44%



4th Floor

University of Huntington

Hostetler Research Building

Space Summary Report by Floor

August 4, 2009

University of Huntington

Page 3 of 4

Floor: 04

Comments: Demonstration Report

<u>Cost Center</u>	<u>Budget Code</u>	<u>Net Area</u>	<u>Charged Area</u>	<u>Rate</u>	<u>Monthly Cost</u>	<u>Annual Cost</u>
PHYSOLGY	13021	19,624.24	19,624.24	\$10.00	\$16,353.53	\$196,242.36
NEUROSURG	13042	4,502.40	4,502.40	\$10.00	\$3,752.00	\$45,024.01
OB/GYN	13045	12,608.67	12,608.67	\$10.00	\$10,507.22	\$126,086.69
NEUROLGY	13051	5,902.06	5,902.06	\$10.00	\$4,918.38	\$59,020.60
PEDATRCS	13061	788.74	788.74	\$10.00	\$657.28	\$7,887.36
TELECO	36087	150.38	150.38	\$10.00	\$125.32	\$1,503.82
HSEKPNG ZONE 3	38022	229.11	229.11	\$10.00	\$190.93	\$2,291.11
MNTNNCE ZONE 3	38042	5,970.36	5,970.36	\$10.00	\$4,975.30	\$59,703.62
MED CTR UTILITIES	38092	917.76	917.76	\$10.00	\$764.80	\$9,177.57
OTHER - MED CNTR	39062	15,828.59	15,828.58	\$10.00	\$13,190.49	\$158,285.85
CENTRAL SCHEDLNG	99999	970.77	970.77	\$10.00	\$808.97	\$9,707.67
	Floor Total	67,493.09	67,493.07	\$10.00	\$56,244.22	\$674,930.66

04-4390-05-Departmental

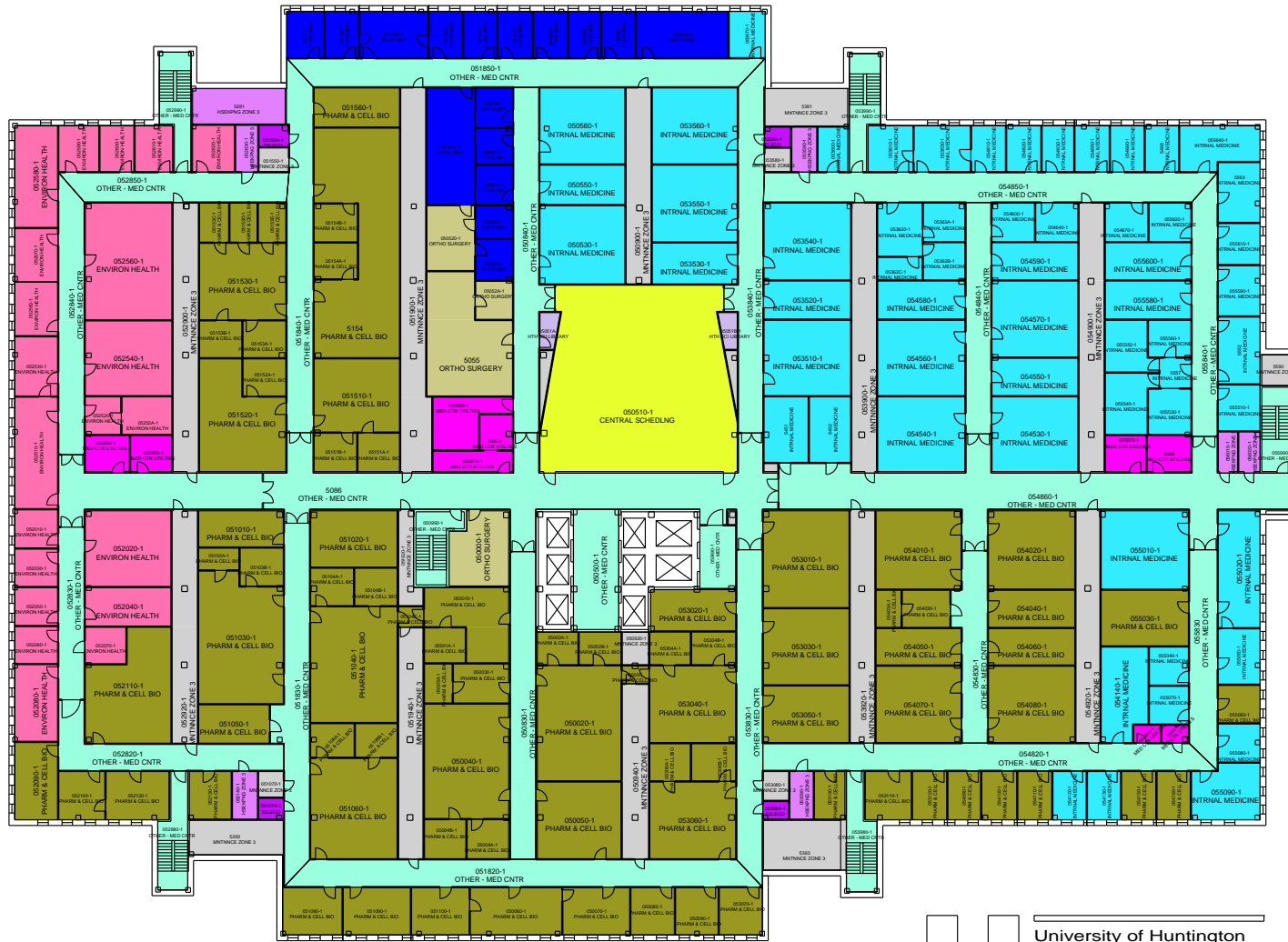

- No data
11 SF 0.02%
- INTRNAL MEDICINE
12,803 SF 18.97%
- PHYS MED
2,306 SF 3.42%
- ORTHO SURGERY
1,235 SF 1.83%
- PHARM & CELL BIO
20,368 SF 30.18%
- ENVIRON HEALTH
4,523 SF 6.70%
- HTH SCI LIBRARY
92 SF 0.14%
- TELECO
159 SF 0.24%
- HSEKPNG ZONE 3
680 SF 1.01%
- MNTNNCE ZONE 3
5,781 SF 8.57%
- MED CTR UTILITIES
948 SF 1.40%
- OTHER - MED CNTR
16,261 SF 24.09%
- CENTRAL SCHEDLNG
2,327 SF 3.45%

5th Floor

University of Huntington
Hostetler Research Building

Space Summary Report by Floor

August 4, 2009

University of Huntington

Page 4 of 4

Floor: 05

Comments: Demonstration Report

<u>Cost Center</u>	<u>Budget Code</u>	<u>Net Area</u>	<u>Charged Area</u>	<u>Rate</u>	<u>Monthly Cost</u>	<u>Annual Cost</u>
INTRNAL MEDICINE	13033	12,803.28	12,803.28	\$10.00	\$10,669.40	\$128,032.78
PHYS MED	13037	2,305.69	2,305.69	\$10.00	\$1,921.41	\$23,056.86
ORTHO SURGERY	13048	1,234.65	1,234.65	\$10.00	\$1,028.87	\$12,346.45
PHARM & CELL BIO	13091	20,367.62	20,367.61	\$10.00	\$16,973.01	\$203,676.07
ENVIRON HEALTH	13096	4,523.24	4,523.23	\$10.00	\$3,769.36	\$45,232.34
HTH SCI LIBRARY	32038	92.22	92.22	\$10.00	\$76.85	\$922.24
TELECO	36087	158.65	158.65	\$10.00	\$132.21	\$1,586.53
HSEKPNG ZONE 3	38022	679.96	679.96	\$10.00	\$566.63	\$6,799.58
MNTNNCE ZONE 3	38042	5,781.34	5,781.34	\$10.00	\$4,817.78	\$57,813.39
MED CTR UTILITIES	38092	947.99	947.99	\$10.00	\$789.99	\$9,479.86
OTHER - MED CNTR	39062	16,260.53	16,260.53	\$10.00	\$13,550.44	\$162,605.26
CENTRAL SCHEDLNG	99999	2,326.59	2,326.59	\$10.00	\$1,938.82	\$23,265.86
	Floor Total	67,493.09	67,493.05	\$10.00	\$56,234.77	\$674,817.21